

INSTRUCTION MANUAL



KEPCO An ISO 9001 Company.

CS 07

CHASSIS SLIDES MODEL CS 07

1. DESCRIPTION

Chassis Slides Model CS 07 contains the components required to install a pair of chassis slides on Kepco KLN Series 1U or 2U power supplies. The slides are designed to mount the KLN units in a standard 19-inch wide cabinet that is at least 30 inches deep.

CAUTION: Use of components not provided herein may damage the unit and void the warranty.

2. INSTALLATION OF CHASSIS SLIDES

2.1 MATERIAL REQUIRED (SEE TABLE 1.)

TABLE 1. MATERIAL SUPPLIED

MATERIAL	KEPCO PART NUMBER	QUANTITY
One pair of slides (includes cabinet, intermediate and chassis sections, rear bracket and factory-installed front bracket)	108-0496	1
* Screw, Truss Head, Phillips drive, M5 x 15mm with plastic washer (bag marked M5 x 15 + W, 10 SET)	501-0096	10
* Screw, Truss Head, Phillips drive, M4 X 8mm, steel (bag marked M4 x 8, 10 PCS)	501-0095	10
* Screw, Truss Head, Low Profile, Phillips drive, M4 X 8mm, steel (bag marked M4 x 8 LP, 4 PCS)	501-0097	4
* Nut, Hex, Flange, Binding, M4, 7mm, ACF, Steel, 5mm thk, 10mm flange dia. (bag marked M4 NUT, 4 PCS)	502-0015	4
* Speed Nut, M5, 10 X 10mm, SA, 5mm thk, Steel (bag marked M5 NUT, 12 PCS)	502-0016	12
CS 07 Instruction Sheet	228-1856	1

* Included with P/N 108-0496

2.2 PROCEDURE

1. The slides are shipped pre-assembled, except for the rear bracket (see Figure 1).

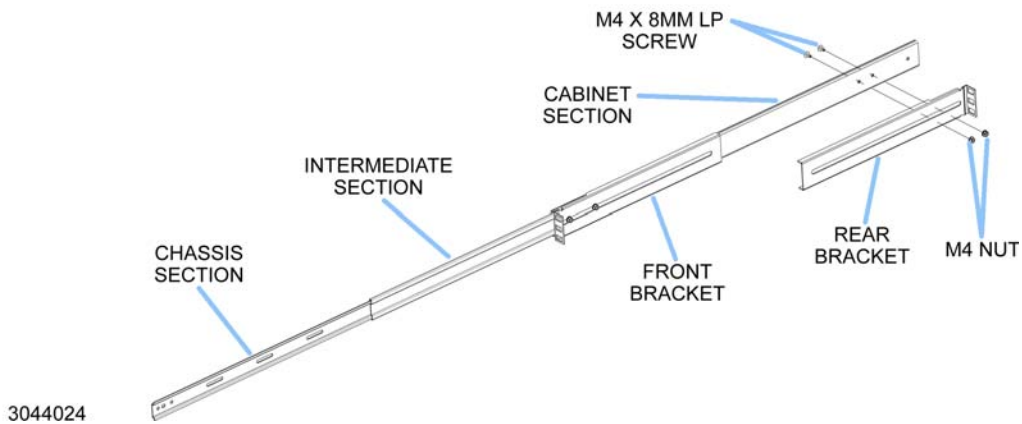

FIGURE 1. CHASSIS SLIDES COMPONENTS, SHOWN EXTENDED

2. The slides are shipped retracted (fully closed). If the intermediate section is fully extended from the cabinet section it will lock. If it is locked, move the cabinet/intermediate section release lever (see Figure 2) as necessary to fully retract the intermediate section into the cabinet section.

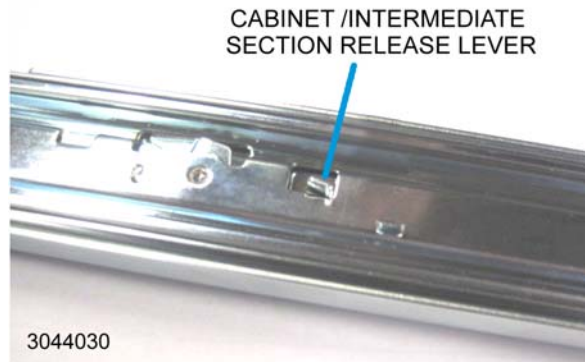

FIGURE 2. CABINET/INTERMEDIATE SECTION RELEASE LEVER

3. Separate chassis section of each slide from intermediate section (See Figure 3) by sliding the chassis section out of the intermediate section. When movement stops, slide the green locking lever as needed to release the chassis section. Release the locking lever and remove the chassis section.

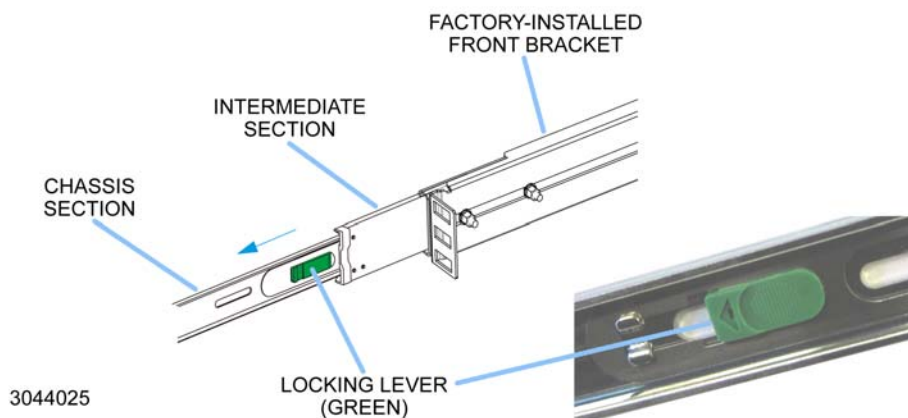

FIGURE 3. CHASSIS SECTION REMOVAL

NOTE: Verify that two mounting ears are installed on the KLN power supply before attaching the chassis sections to the power supply. If not, see KLN Operator Manual for installation details. The manual is available for free download at www.kepcopower.com/support/opmanls.htm#kln.

4. Attach each chassis section to side of KLN power supply as shown in Figure 4. The plastic end of the chassis section should be against the ear bracket. Use three M4 x 8mm screws on each side for 1U models and four M4 x 8mm screws on each side for 2U models.

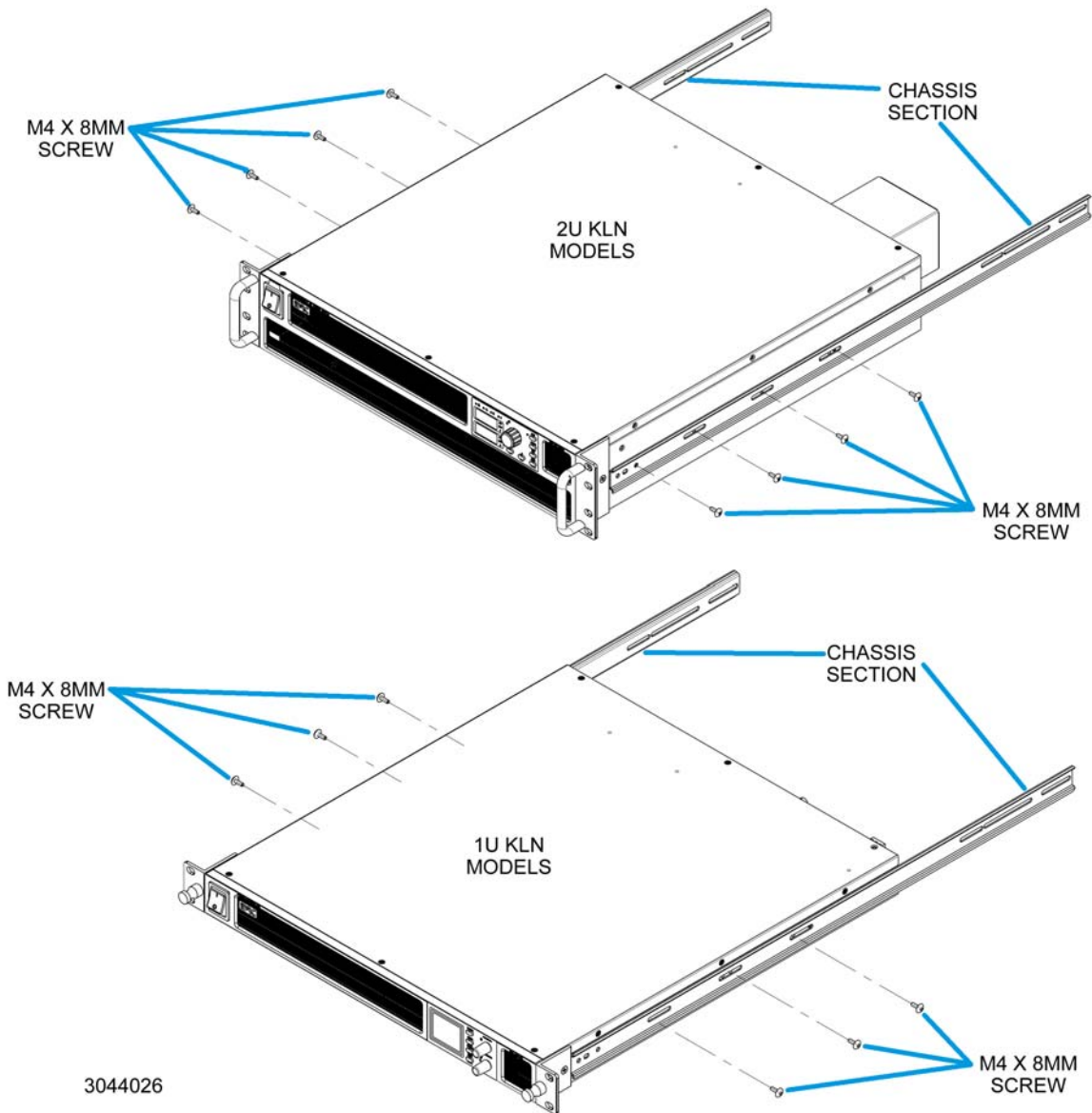

FIGURE 4. ATTACHING CHASSIS SECTION TO POWER SUPPLY.

5. Attach rear bracket to each cabinet section using M4 X 8mm LP screws and M4 threaded nuts as shown in Figure 1 (hand tighten only)
6. Attach front and rear brackets to the cabinet rails using M5 screws and plastic washers as shown in Figure 5. Adjust the front and rear brackets to accommodate the cabinet by loosening nuts securing the front and rear brackets to the cabinet section of the slide. Be sure nuts on front bracket do not obstruct rail. Once the two brackets are installed and adjusted, tighten M4 nuts (torque: 1.0 N-m, 8.8 lb-in). If the rail has square holes, M5 speed nuts are provided. If the rail does not have threaded holes, install the M5 speed nuts on the front and rear brackets, then install the bracket behind the rail.

NOTE: Both front and rear brackets must be secured to the rail to support the weight of the unit.

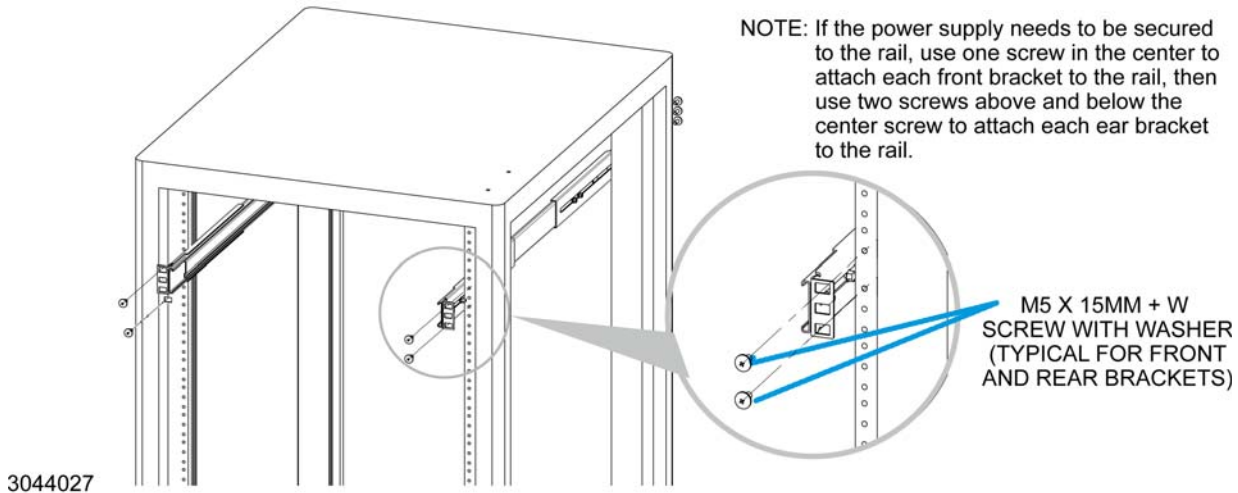

FIGURE 5. INSTALLING FRONT AND REAR BRACKETS ON CABINET RAILS

7. Insert KLN power supply into rack by aligning power supply-mounted chassis section into the tracks of the cabinet-mounted intermediate section. The intermediate section must be in the full forward position as shown in Figure 6. Slide unit into the cabinet until the slides lock. Release the locking levers (see Figure 3) on each side, and slide the unit into the cabinet in one continuous motion.
8. To completely remove a unit from the cabinet, grasp the knobs on the ear brackets and pull the unit out until the locks engage. Release both locking levers (see Figure 3) and slide the unit clear of the cabinet.

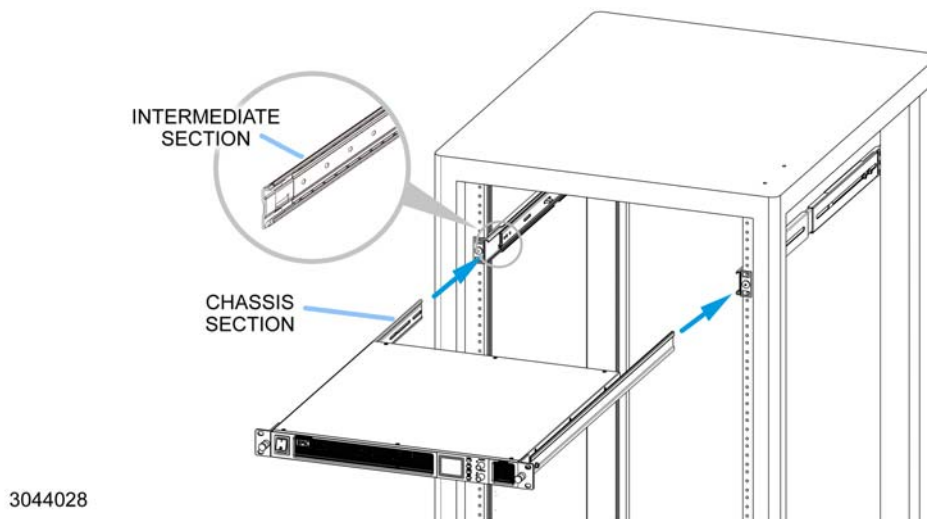

FIGURE 6. INSTALLING POWER SUPPLY INTO CABINET