

INSTRUCTION MANUAL



KEPCO An ISO 9001 Company.

**PC 15
FOR
BOP 100W,
200W, 400W**

REAR PROGRAMMING CONNECTOR WIRED FOR FRONT PANEL CONTROL

DESCRIPTION: The Kepco Model PC 15 is a 50 terminal connector, equipped with cable shell, cable clamp and locking screws. The PC-15 is pre-wired to provide the correct termination for local (front panel) control of Kepco BOP 100W, BOP 200W and BOP 400W Models. There are two versions of the PC 15: both serve the same purpose; one uses connector P/N 195-0039 and the latest version uses connector P/N 195-0121. Refer to Figure 4 for a Mechanical Outline Drawing.

For 195-0039 (see Figure 1), wires are added directly to the terminals for local control. User-added wires or components are connected directly to the terminals.

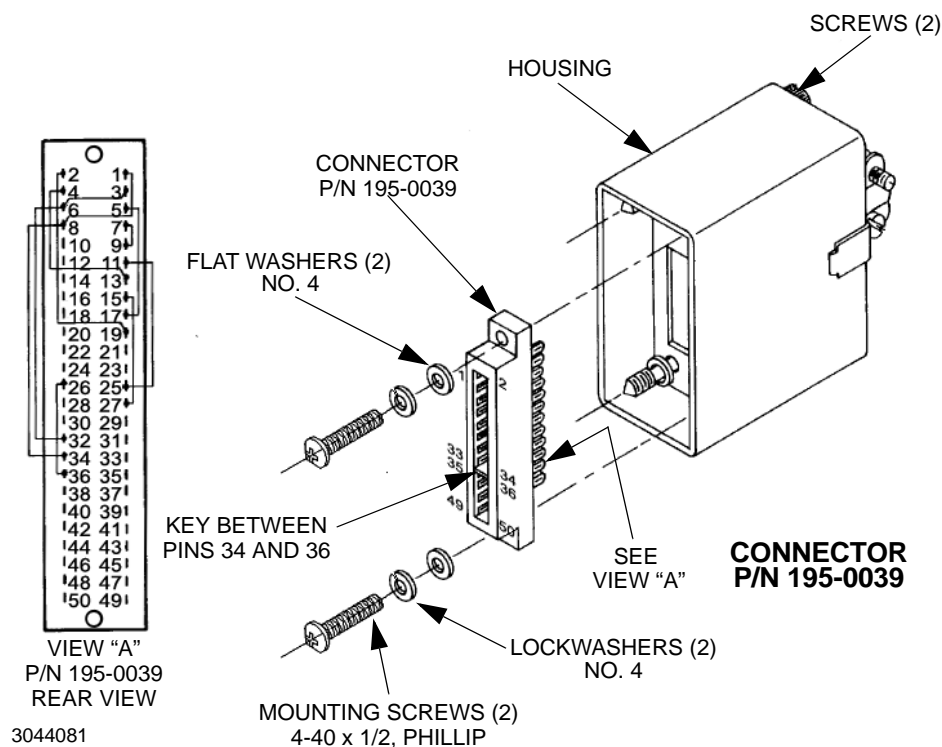

FIGURE 1. PC 15 REAR PROGRAMMING CONNECTOR USING P/N 195-0039.

For P/N 195-0121 (see Figure 2) connections are made via the PWB traces and test points installed at the factory. Table 1 lists the pins connected when the test points are installed. For complete PWB connections, refer to the schematic diagram, Figure 3. For P/N 195-0121 if necessary to isolate any pins connected by a test point, cut the test point. **CAUTION: Improper soldering technique may damage the PWB beyond repair.** Holes are provided at the test points for user-added wires or components. In addition, three holes per pin are provided on the PWB for user-added wires or components.

NOTE: PC 12 (unwired) is supplied either without wires or without test points, depending on the connector used.

KEPCO, INC. ● 131-38 SANFORD AVENUE ● FLUSHING, NY. 11355 U.S.A. ● TEL (718) 461-7000 ● FAX (718) 767-1102
http://www.kepcopower.com ● email: hq@kepcopower.com

TABLE 1. P/N 195-0121 TEST POINT CONNECTIONS

TEST POINT	PINS CONNECTED WHEN TEST POINT INSTALLED		TEST POINT	PINS CONNECTED WHEN TEST POINT INSTALLED		TEST POINT	PINS CONNECTED WHEN TEST POINT INSTALLED	
TP1	PIN 1	PIN 8	TP5	PIN 3	PIN 32	TP9	PIN 11	PIN 25
TP2	PIN 1	PIN 34	TP6	PIN 4	PIN 13	TP10	PIN 15	PIN 27
TP3	PIN 2	PIN 19	TP7	PIN 5	PIN 17	TP11	PIN 26	PIN 36
TP4	PIN 3	PIN 6	TP8	PIN 7	PIN 9			

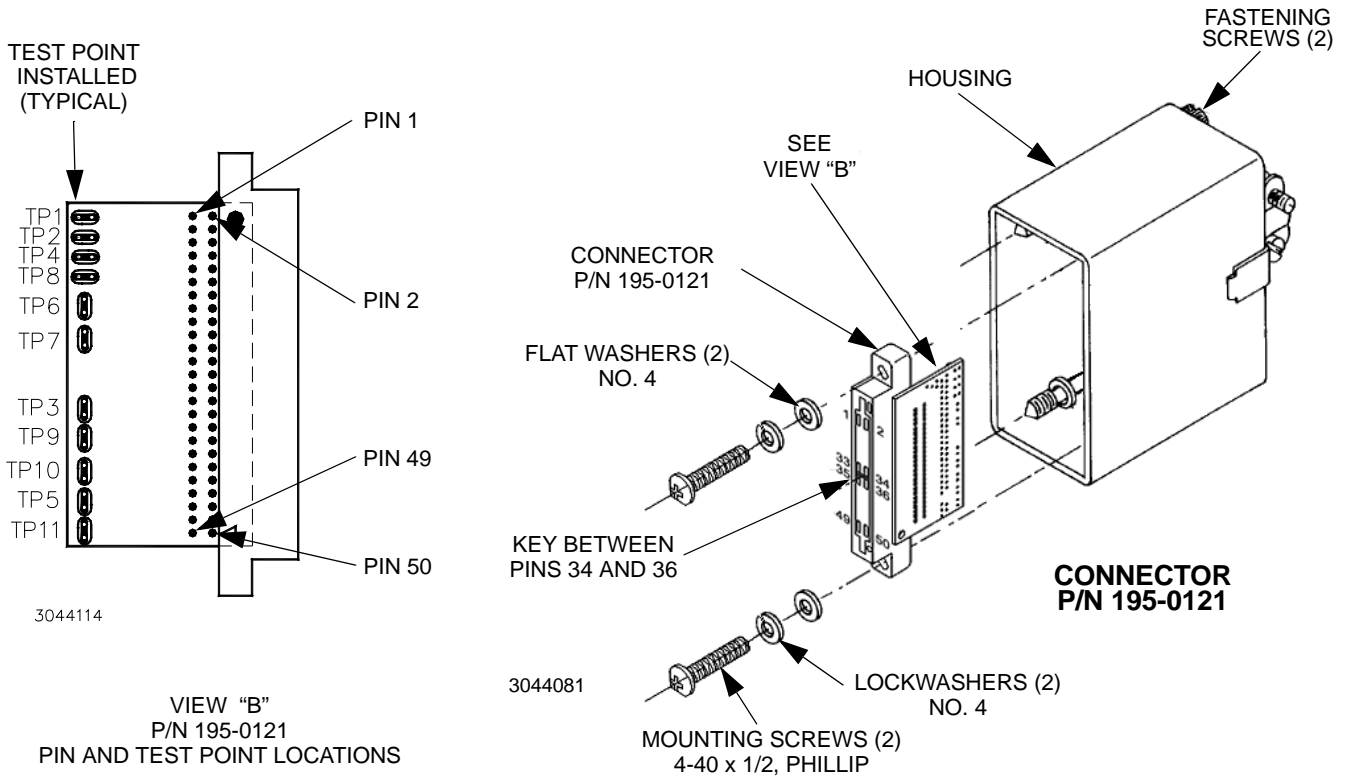

FIGURE 2. PC 15 REAR PROGRAMMING CONNECTOR USING P/N 195-0121.

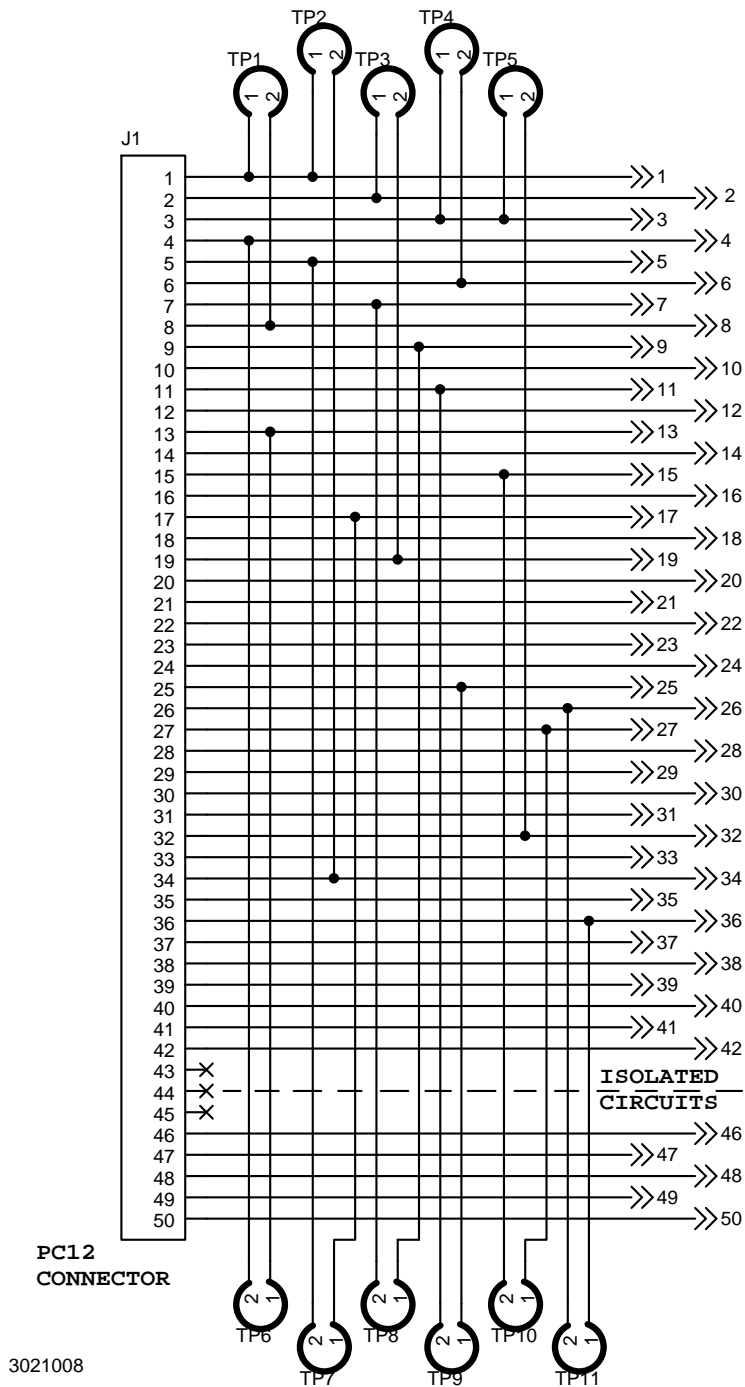
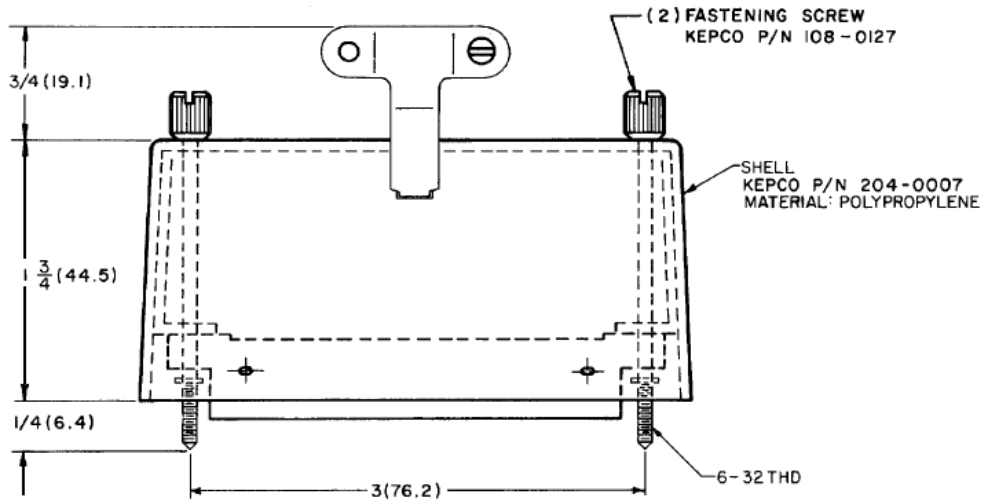

FIGURE 3. P/N 195-0121 PRINTED WIRING BOARD, SCHEMATIC DIAGRAM

INSTALLATION

1. Unpack the Model PC 15 connector from the polyethylene bag.
2. Mate connector with the BOP rear edge connector.
3. Secure Model PC-15 connector to the chassis of the BOP by engaging and hand-tightening the two knurled fastening screws.



NOTE:
DIMENSIONS, GIVEN IN INCHES
AND (MILLIMETERS), ARE FOR
REFERENCE ONLY.

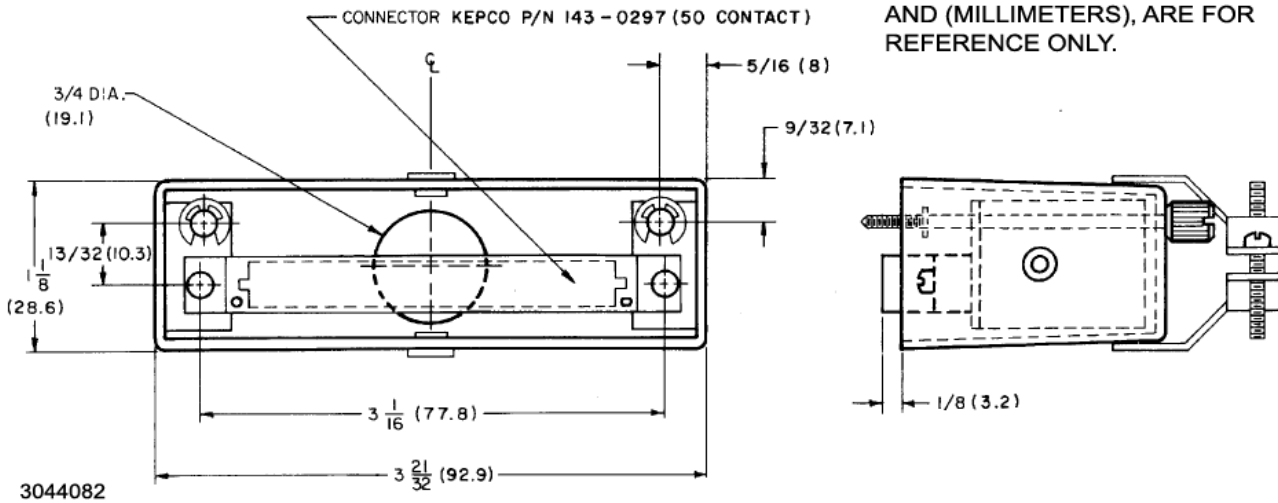

FIGURE 4. MECHANICAL OUTLINE DRAWING, MODEL PC 15